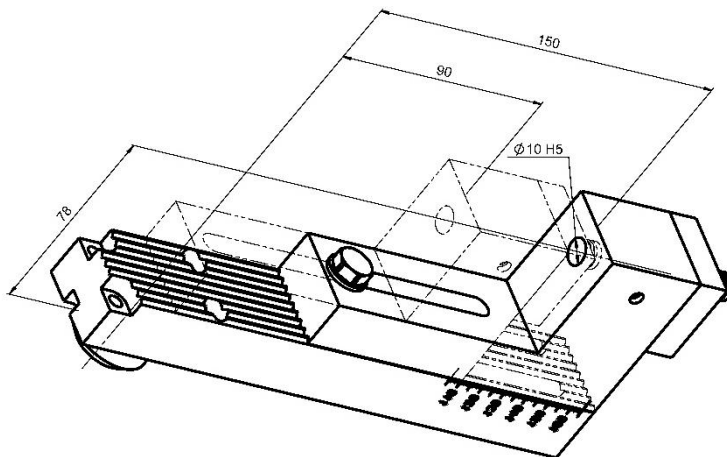
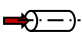

GDF1601-1x10-II

Machine: CITIZEN Cincom
Type: L32-VIII/IX/X/XII
Emplacement, N°: Upper gang tool post

Travail sur: Broche principale

Type de travail: 

n_{max} : - [rpm]

i (n_i / n_o): - / -

Attachement: $\varnothing 10 H5$

Avec refroidissement

Infos: Boîtier à 165mm de la broche principale

Réglable sur l'axe Z

Compatible avec les blocs linéaires U30B et U32B

Kit d'arrosage : 875-992-80

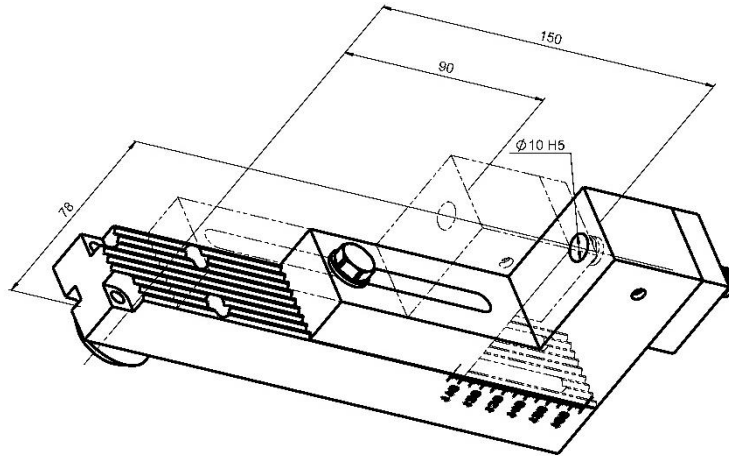
GDF1601-1x10-II

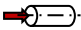
Machine: CITIZEN Cincom
Type: L32-VIII/IX/X/XII
Location, N°: Upper gang tool post
Work on: Main spindle
Type of work: 
n_{max}: - [rpm]
i (n_i / n_o): - / -
Attachement: Ø 10 H5

With coolant

Infos: Housing 165mm from the main spindle

Adjustable in Z axis

Compatible with linear blocks U30B and U32B

Coolant Kit : 875-992-80

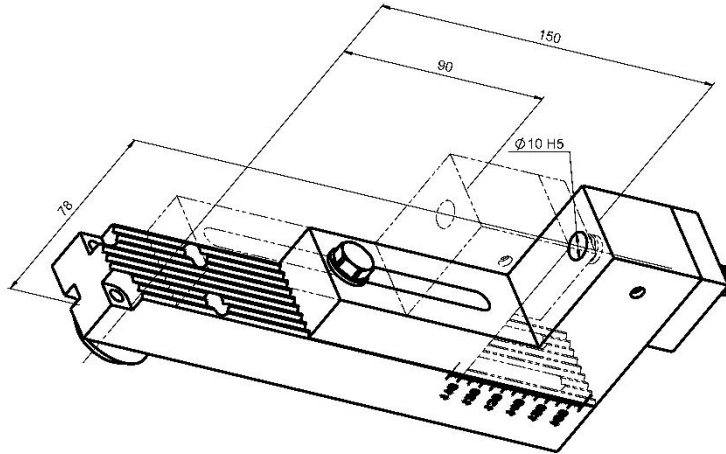
GDF1601-1x10-II

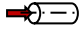
Maschine: CITIZEN Cincom
Typ: L32-VIII/IX/X/XII
Position, N°: Upper gang tool post
Arbeit über: Hauptspindel
Arbeitstyp: 
n_{max}: - [rpm]
i (n_i / n_o): - / -
Befestigung: Ø 10 H5

Kühlmittel

Infos: Gehäuse 165mm von der Hauptspindel entfernt

In Z Achse verstellbar

Kompatibel mit den Linearblöcken U30B und U32B

Kühlmittel Kit :875-992-80

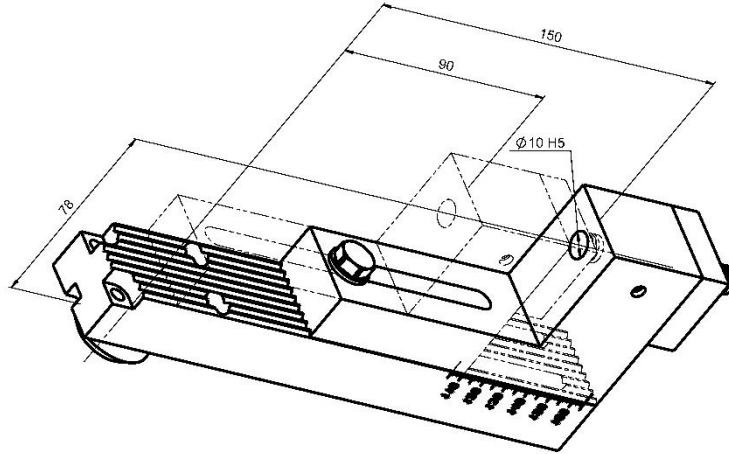
GDF1601-1x10-II

Macchina: CITIZEN Cincom
Tipo: L32-VIII/IX/X/XII
Posizione, N°: Upper gang tool post

Lavoro al: Mandrino principale

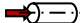
Tipo di lavoro: 

n_{max} : - [rpm]

i (n_i / n_o): - / -

Ataccamento: Ø 10 H5

refrigerante

Informazioni: Alloggiamento a 165 mm dal mandrino principale

Asse Z regolabile

Compatibile con i blocchi lineari U30B e U32B

Kit refrigerante :875-992-80